

THE CELLAR AND FIRST FLOOR FRAME

Both the cellar and first floor frame have been greatly altered by later work, and provide little physical evidence to aid our inquiry. The east half of the cellar (**the lower part of the drawing at right, probably c. 1981 by former curator Nancy Rexford**) was only excavated in 1981, and the floor framing entirely replaced. The original framing in the west half of the cellar was replaced sometime earlier.

According to Rexford's plan and her supporting notes, the evenly-spaced stringers under the easterly room lay over an unexcavated crawlspace. The stair leading from this room to the cellar under the west end of the house was composed of half logs. Unfortunately, this log staircase was lost in the course of excavation, and we can not know whether it and the west cellar are original to the house.

The ell still lies over unexcavated crawlspace. The stairwell from the ell to the westerly cellar is relatively late (c. 1800).

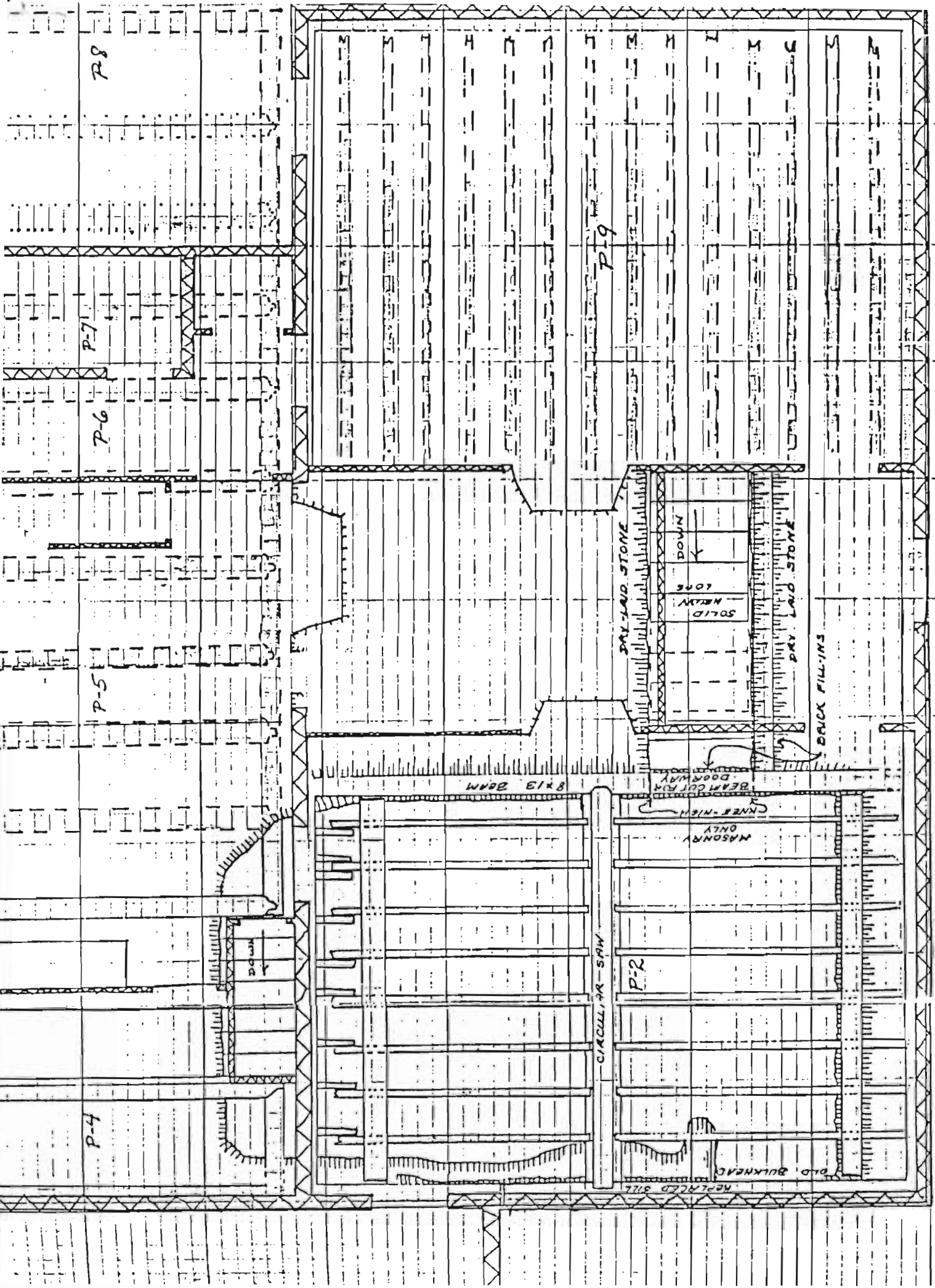



P-8

P-7

P-6

P-5

P-4

P-9

DRY LAID STONE

SOLID MASONRY

DOWN

DRY LAID STONE

BRICK FILLING

8x13 BEAM

BEAM CUT FOR DOORWAY

KNIFE-NICK

MASONRY ONLY

CIRCULAR SAW

P-2

OLD BULKHEAD

REPLACED SILL

C